



# THE CITY OF WINNIPEG

## PUBLIC WORKS DEPARTMENT

### ENGINEERING DIVISION

# 2019 LOCAL STREET RENEWAL PROGRAM

## AINSLIE STREET, LODGE AVENUE AND VARIOUS OTHER LOCATIONS

### PAVEMENT REHABILITATION AND RECONSTRUCTION

#### BID OPPORTUNITY 60-2019 - CONTRACT #2

**DRAWING NO.**

**DESCRIPTION**

60-2019_DRAWING_18M-01969-00-14-RC	AINSLIE STREET- LODGE AVENUE TO BRUCE AVENUE PAVEMENT REHABILITATION STA. 1+00 TO STA. 2+55
60-2019_DRAWING_18M-01969-00-15-RC	AINSLIE STREET- LODGE AVENUE TO BRUCE AVENUE PAVEMENT REHABILITATION STA. 2+55 TO STA. 4+12.22
60-2019_DRAWING_18M-01969-00-16-RC	LODGE AVENUE - MORAY STREET TO DAVIDSON STREET PAVEMENT REHABILITATION STA. 1+00 TO STA. 2+50
60-2019_DRAWING_18M-01969-00-17-RC	LODGE AVENUE - MORAY STREET TO DAVIDSON STREET PAVEMENT REHABILITATION STA. 2+50 TO STA. 3+95
60-2019_DRAWING_18M-01969-00-18-RC	LODGE AVENUE- MORAY STREET TO DAVIDSON STREET PAVEMENT REHABILITATION STA. 3+95 TO STA. 5+60
60-2019_DRAWING_18M-01969-00-19-RC	LODGE AVENUE - MORAY STREET TO DAVIDSON STREET PAVEMENT REHABILITATION STA. 5+60 TO STA. 7+20
60-2019_DRAWING_18M-01969-00-20-RC	LODGE AVENUE - MORAY STREET TO DAVIDSON STREET PAVEMENT REHABILITATION STA. 7+20 TO STA. 8+70
60-2019_DRAWING_18M-01969-00-21-RC	LODGE AVENUE - MORAY STREET TO DAVIDSON STREET PAVEMENT REHABILITATION STA. 8+70 TO STA. 10+07.50
60-2019_DRAWING_18M-01969-00-22-RC	STRATHCONA STREET - ST MATTHEWS AVENUE TO ELLICE AVENUE ASPHALT RECONSTRUCTION STA. 1+00 TO STA. 2+20
60-2019_DRAWING_18M-01969-00-23-RC	STRATHCONA STREET - ST MATTHEWS AVENUE TO ELLICE AVENUE ASPHALT RECONSTRUCTION STA. 2+20 TO STA. 3+40
60-2019_DRAWING_18M-01969-00-24-RC	STRATHCONA STREET - ST MATTHEWS AVENUE TO ELLICE AVENUE ASPHALT RECONSTRUCTION STA. 3+40 TO STA. 4+44.78
60-2019_DRAWING_18M-01969-00-25-RC	TRAILL AVENUE - PORTAGE AVENUE TO MT ROYAL ROAD PAVEMENT REHABILITATION STA. 1+00 TO STA. 2+10
60-2019_DRAWING_18M-01969-00-26-RC	TRAILL AVENUE - PORTAGE AVENUE TO MT ROYAL ROAD PAVEMENT REHABILITATION STA. 2+10 TO STA. 3+30
60-2019_DRAWING_18M-01969-00-27-RC	TRAILL AVENUE - PORTAGE AVENUE TO MT ROYAL ROAD PAVEMENT REHABILITATION STA. 3+30 TO STA. 4+18.83

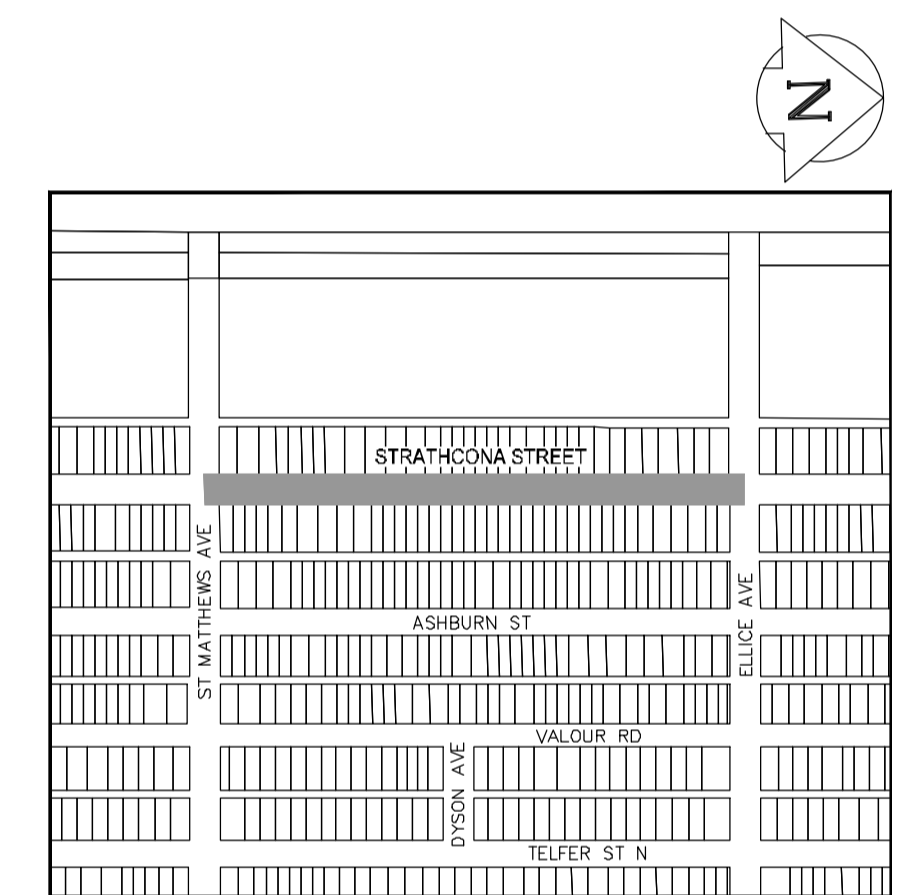
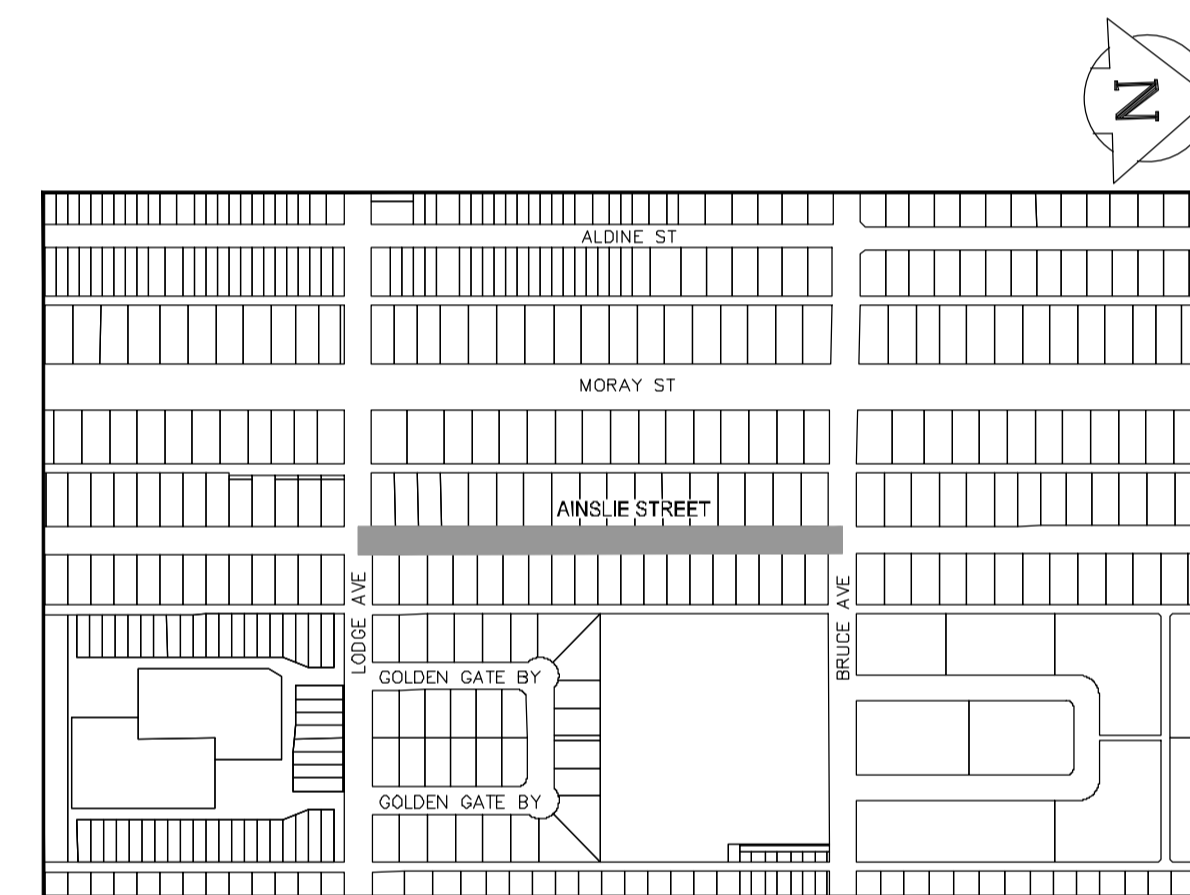

May 07 2019 - 3:45pm  
 P:\2018\18M-01969-00 - 2019 Local Streets Package\_19-R-03\Contract 2\10 Drawings\03 Working Drawings\18M-01969-Cover Page\Contract #2.dwg - tab:60-2019-Cover page\_18M-01969-00-00-RC



WSP Canada Group Limited  
 Suite 111 - 93 Lombard Ave  
 Winnipeg, MB R3B 3B1  
 t. 204.943.3178  
 f. 204.943.4948  
 www.wsp.com



ISSUED FOR TENDER

RELEASE FOR CONSTRUCTION BY:

JASON DOERKSEN, CET STREET PROJECT COORDINATOR

DATE